



# HAVE YOUR SAY ON THE FUTURE OF COMMUNITY FACILITIES IN THORNBURY

South Gloucestershire Council, Thornbury Town Council (also as Trustee of the Armstrong Hall), and the Trustees of Turnberrie's have been working together over the past six months to look at where community facilities in Thornbury could best be located in the future to support our growing community. Together, we want to understand your views and ideas on the proposals which could affect the Armstrong Hall, Thornbury Library, Turnberrie's Community Centre and Thornbury & District Museum. The project has received some government funding through the One Public Estate Project to explore the feasibility of making best use of publically owned facilities through closer partnership working, for the benefit of the community.

## OPTIONS AFFECTING THE ARMSTRONG HALL

It is a long standing community aspiration to see the Armstrong Hall complex improved and modernised and it is currently in need of significant refurbishment to enable its continued long-term use and to ensure it can provide the standard of facilities to support our growing community. The Armstrong Hall site is owned by The Armstrong Hall Charitable Trust and the Town Council is the sole managing trustee, who will make the decision on its preferred future location. The site includes the Armstrong Hall, Cossham Hall, Bakery Annex, Museum and Miss Saises Cottage (which fronts the High St).



**THERE ARE TWO OPTIONS UNDER CONSIDERATION FOR THE FUTURE PROVISION OF FACILITIES CURRENTLY PROVIDED AT THE ARMSTRONG HALL:**

**OPTION 1 : Refurbish and extend on the existing Armstrong Hall site to modernise the facilities provided**



Armstrong Hall



Artist impression

This option would involve refurbishment of the entire complex and the provision of new extensions to the rear and to replace the bakery annex to provide changing rooms and additional multi-purpose community meeting space.

This option could see the following works undertaken and facilities provided:

- Provision of four multi-use changing rooms to the rear of the stage area including toilets and showers
- Upgraded toilet, bar and kitchen facilities
- Upgrade of heating, ventilation, insulation and electrical systems to make the building more efficient to run

- Repairs to roofs and replacement of doors and windows
- The provision of several additional flexible use meeting rooms of various sizes and associated facilities (to replace the bakery annex)
- Refurbishment and redecoration of the Cossham Hall, Armstrong Hall (including a new floor) and other existing public areas

This option is currently estimated to cost in the region of £3.5 million\*. Which could potentially be funded through a mixture of developer contributions (s106 & CIL), town council funds, grants and local fundraising efforts.

*\*This figure is an estimate only and is likely to change as further details are known and the project evolves*

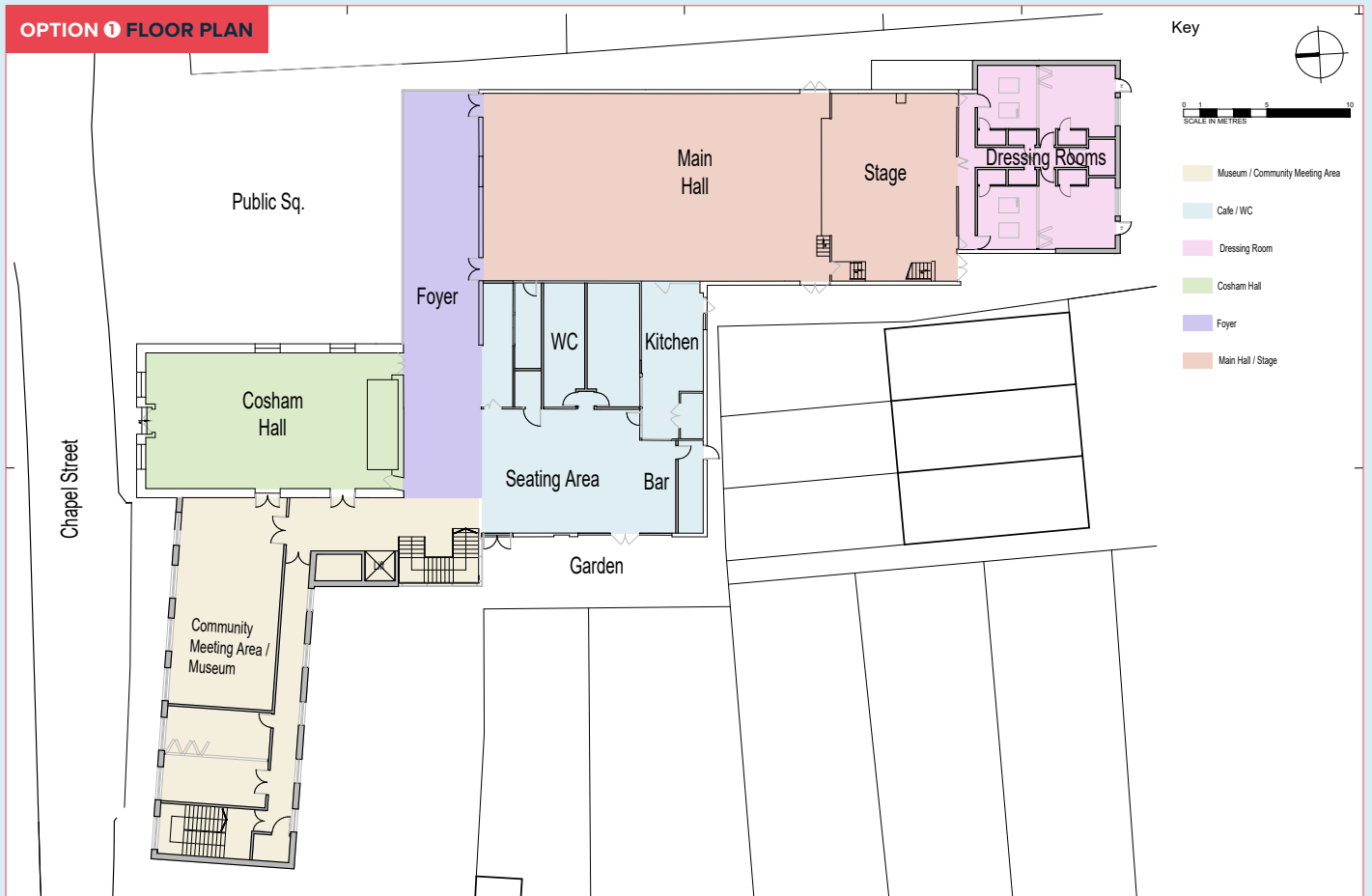

**OPTION 2 : Build a new extension onto Turnberries that could provide improved community facilities**

This option would involve building a large extension on the area to the side of Turnberries to provide a new performance hall, larger stage and performance space, changing rooms and additional multi-purpose community meeting space in addition to the existing facilities on the site. Turnberries is owned by South Gloucestershire Council and is currently operated and managed by the Thornbury Community Building Trust with community trustees, any decision on this option will be made jointly by all three parties.

This option could see the following facilities provided in addition to the ones currently available at Turnberries:

- Large performance hall with a maximum seating capacity of 450 including utilising the stage area. This space could be used as one large conference or function hall or be subdivided to provide either two separate hireable spaces or used as a performance hall seating up to 350 and stage area.
- Large stage area and wings (approx double the size of the existing Armstrong Hall stage space), and associated staging, sound and lighting rigs with stage door access and technical box.
- Retractable seating in the performance area to seat 300
- Foyer, cafe and bar area
- New toilets
- Four changing rooms accessible from either the new performance hall or the existing Turnberries Hall including dedicated toilets and showers
- Additional large meeting room on second floor seating 100 with toilets and kitchenette



Turnberries



Artist impression

This option is currently estimated to cost in the region of £4 to £5million\*. If this option is taken forward the Armstrong Hall site would be sold for redevelopment and the proceeds used to part fund the new extension at Turnberries. The remaining cost of this option could potentially be funded through a mixture of developer contributions (s106 & CIL), town council funds, grants and local fundraising efforts.

*\*This figure is an estimate only and is likely to change as further details are known and the project evolves*

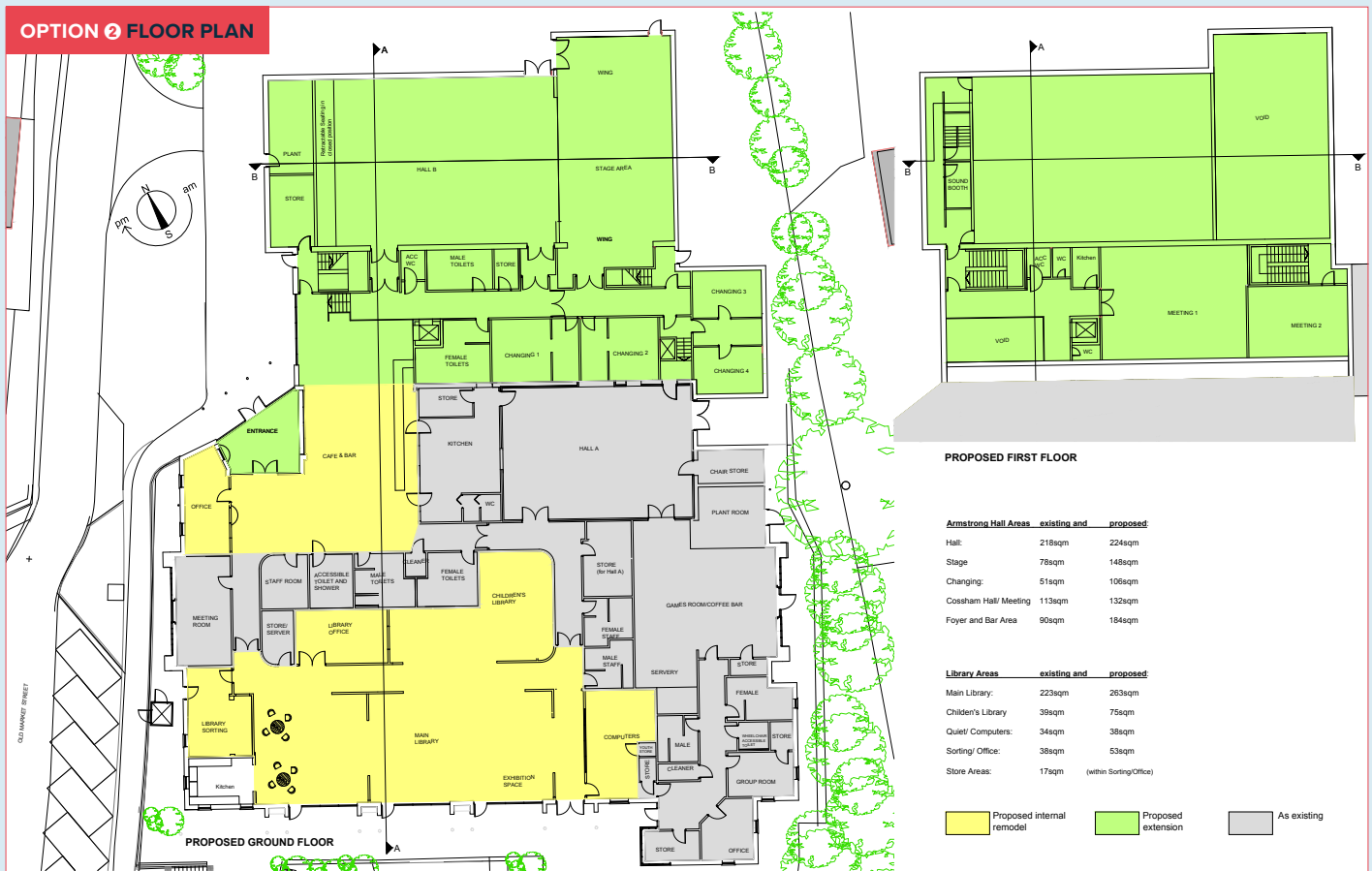



## THORNBURY & DISTRICT MUSEUM



The decision on the future of the Armstrong Hall could also have an impact on the Museum which is based on the current Armstrong Hall site and serves the wider district of the Lower Severn Vale. The Town Council is committed to working with the Museum Trustees to ensure that they have a suitable long-term base from which to operate from, whichever option is eventually progressed for the Armstrong Hall site. At the current time no specific alternative location for the museum has been agreed and a number of options are being considered which could see the museum stay in its current location, be incorporated into a wider redevelopment of the Armstrong Hall site or relocate to another local site. It is not possible due to the space requirements and specialist facilities needed by the museum for it to be incorporated into the Turnberries site.

## POTENTIAL RELOCATION OF THORNBURY LIBRARY



South Gloucestershire Council who are responsible for library services are considering the option of moving the library service to space in the Turnberries Centre which will require some remodelling work to the existing Turnberries building in order to facilitate this. The existing library building is coming to the end of its useful life and hence is not in a good state of repair. It will require considerable investment in the near future, while there is currently a space at Turnberries, which is larger than the existing library, that could accommodate the service. There may be additional benefits to the town of co-locating cultural and other community facilities in the same space. Any potential library move is not dependent on the future location of facilities currently provided at the Armstrong Hall. The layout of the potential library space will be agreed with the Turnberries Trustees to minimise the impact on areas currently available to the community to use and hire.

*See floorplan on page 7.*

If the library were re-located it is likely to offer the following services and facilities:

- Larger library space and children's area
- Computer room
- Exhibition space
- Flexible meeting space
- Open Access facility to provide extended opening hours when unstaffed

The cost of this option is included in the overall figure for developing at Turnberries (£4-5M) and the library element could be met by S106 developer contributions, capital receipt from the sale of the existing Library site and from existing South Gloucestershire Council capital programme funding.

*\*This figure is an estimate only and is likely to change as further details are known and the project evolves*

## HOW TO HAVE YOUR SAY

**A decision on the future of these important facilities is expected to be taken by Thornbury Town Council, Armstrong Hall Charitable Trust, South Gloucestershire Council and the Turnberries Trustees later in the Autumn. To help inform these decisions, we are seeking views from local people throughout September 2017, which will be considered as part of the decision making process.**

The consultation will open on 1 September and run until 29 September 2017. We are jointly holding three consultation drop-in sessions where further information and staff will be available to answer any questions that you may have about these options and proposals. These sessions are taking place on:

- **Tuesday 12 Sept** (2pm to 7pm) at Turnberries
- **Wednesday 13 Sept** (2pm to 7pm) at Thornbury Library
- **Thursday 14 Sept** (2pm to 7pm) at the Armstrong Hall

Further information and a link to our online survey is available from each organisations website or from this link: [www.southglos.gov.uk/consultation](http://www.southglos.gov.uk/consultation)

Copies of the consultation survey can also be picked up from Thornbury Town Hall, Thornbury Library, The Armstrong Hall or Turnberries Community Centre throughout the consultation period.

You can also tell us your views by emailing: [consultation@southglos.gov.uk](mailto:consultation@southglos.gov.uk)

Or writing to: **Freeport RTXL-YJXJ-BXEX  
South Gloucestershire Council  
Corporate Research & Consultation Team  
Thornbury Community Facilities  
Council offices  
Badminton Road  
Yate  
BRISTOL  
BS37 5AF**

You can also call **01454 412103**.

## FUTURE OF COMMUNITY FACILITIES IN THORNBURY CONSULTATION SURVEY

To help us gather views on the options and proposals set out in this consultation, we would be grateful if you could respond using this survey. Alternatively comments can be made in writing (email or post) by phone or in person at one of our consultation events, details of which are listed at the end of this survey.

### How often have you used the following facilities in the past two years?

	Daily	Weekly	Fortnightly	Monthly	Occasionally	Not used
Armstrong Hall	<input type="checkbox"/>	<input type="checkbox"/>	<input type="checkbox"/>	<input type="checkbox"/>	<input type="checkbox"/>	<input type="checkbox"/>
Thornbury Library	<input type="checkbox"/>	<input type="checkbox"/>	<input type="checkbox"/>	<input type="checkbox"/>	<input type="checkbox"/>	<input type="checkbox"/>
Turnberries	<input type="checkbox"/>	<input type="checkbox"/>	<input type="checkbox"/>	<input type="checkbox"/>	<input type="checkbox"/>	<input type="checkbox"/>
Thornbury & District Museum	<input type="checkbox"/>	<input type="checkbox"/>	<input type="checkbox"/>	<input type="checkbox"/>	<input type="checkbox"/>	<input type="checkbox"/>

### What have you used these community facilities for?

- |  |  |
|--|--|
| <input type="checkbox"/> Library services                            | <input type="checkbox"/> Use computers                     |
| <input type="checkbox"/> Performance space                           | <input type="checkbox"/> Meeting space for community group |
| <input type="checkbox"/> To attend a session or class                | <input type="checkbox"/> To attend an event                |
| <input type="checkbox"/> To attend a show, performance or production | <input type="checkbox"/> Private hire/function             |
| <input type="checkbox"/> Children's activities                       | <input type="checkbox"/> Youth Centre                      |
| <input type="checkbox"/> Museum services                             | <input type="checkbox"/> Cafe and bar                      |

Other, please specify:

## OPTIONS FOR THE FACILITIES CURRENTLY PROVIDED AT THE ARMSTRONG HALL

### Which option for the future location of community facilities currently provided at the Armstrong Hall do you prefer?

- |   |   |
|---|---|
| <input type="checkbox"/> Refurbishment on the existing site | <input type="checkbox"/> New build extension at Turnberries |
| <input type="checkbox"/> Don't know/No preference           | <input type="checkbox"/> Other option (please specify)      |

Why is this your preferred option?

### What do you think about the proposed plans for the future provision of facilities currently provided at the Armstrong Hall?

### What impact do you think either of the options for the redevelopment of the facilities currently provided at the Armstrong Hall could have on Thornbury or your use of these facilities?

## OPTIONS FOR THE FUTURE LOCATION OF THE LIBRARY

If the library moved to Turnberries, what facilities, services or improvements would you like to see provided?

What do you think about the proposal to move the library to Turnberries?

What impact do you think potentially moving the library could have on the provision of library services or your use of them?

## THORNBURY & DISTRICT MUSEUM

Please use this space to make any comments about the future provision of museum facilities in Thornbury and how these proposals could impact on them.

## TURNBERRIES

Please use this space to make any comments about the community facilities provided at Turnberries and your use of them.

What impact do you think potentially moving the library to Turnberries could have on the future provision of community facilities at Turnberries?

What impact do you think potentially moving the facilities currently provided at the Armstrong Hall to an extension to Turnberries could have on the services and facilities provided at Turnberries?

**Would you use these facilities in the future?**

	Less than now	About the same as now	More than now	Would not use at all	Don't know
Library located at Turnberries	<input type="checkbox"/>	<input type="checkbox"/>	<input type="checkbox"/>	<input type="checkbox"/>	<input type="checkbox"/>
Library in its current location	<input type="checkbox"/>	<input type="checkbox"/>	<input type="checkbox"/>	<input type="checkbox"/>	<input type="checkbox"/>
Armstrong Hall facilities refurbished on existing site	<input type="checkbox"/>	<input type="checkbox"/>	<input type="checkbox"/>	<input type="checkbox"/>	<input type="checkbox"/>
Armstrong Hall facilities provided in an extension to Turnberries	<input type="checkbox"/>	<input type="checkbox"/>	<input type="checkbox"/>	<input type="checkbox"/>	<input type="checkbox"/>
Turnberries Community Centre	<input type="checkbox"/>	<input type="checkbox"/>	<input type="checkbox"/>	<input type="checkbox"/>	<input type="checkbox"/>
Thornbury & District Museum at its current location	<input type="checkbox"/>	<input type="checkbox"/>	<input type="checkbox"/>	<input type="checkbox"/>	<input type="checkbox"/>
Thornbury & District Museum at an alternative local location	<input type="checkbox"/>	<input type="checkbox"/>	<input type="checkbox"/>	<input type="checkbox"/>	<input type="checkbox"/>

**Please use this space to make any other comments about the provision of community facilities in Thornbury that you think are relevant.**

**Are you responding to this consultation as?**

- |   |  |
|---|--|
| <input type="checkbox"/> A local resident               | <input type="checkbox"/> On behalf of an organisation (please specify) |
| <input type="checkbox"/> Current user of Armstrong Hall | <input type="checkbox"/> Current user of Thornbury Library             |
| <input type="checkbox"/> Current user of Turnberries    | <input type="checkbox"/> Current user of Thornbury & District Museum   |
| <input type="checkbox"/> A local business               |  |

Other, please specify:

**Please tell us your full postcode:**

The following questions are optional but will help us to better understand the responses we receive and any impact on particular individuals or groups. You do not need to answer the following questions if you are responding on behalf of an organisation.

**Are you?**  Female  Male  Prefer not to say

**How old are you?**

- |                                   |                                   |  |
|-----------------------------------|-----------------------------------|--|
| <input type="checkbox"/> Under 16 | <input type="checkbox"/> 16 to 25 | <input type="checkbox"/> 26 to 35          |
| <input type="checkbox"/> 36 to 45 | <input type="checkbox"/> 46 to 55 | <input type="checkbox"/> 56 to 65          |
| <input type="checkbox"/> 66 to 75 | <input type="checkbox"/> Over 75  | <input type="checkbox"/> Prefer not to say |

**Your ethnicity:**

- Arab/Arab British
- Asian/Asian British – Bangladeshi
- Asian/Asian British – Indian
- Asian/Asian British – Pakistani
- Asian/Asian British – Chinese
- Asian/Asian British – Other (please state)
- Black/African/Caribbean/Black British – African
- Black/African/Caribbean/Black British – Caribbean
- Black/African/Caribbean/Black British – Other (please state)

- Gypsy or Traveller of Irish Heritage
- Mixed/Multiple Ethnic Groups – White & Asian
- Mixed/Multiple Ethnic Groups – White & Black African
- Mixed/Multiple Ethnic Groups – White & Black Caribbean
- Mixed/Multiple Ethnic Groups – Other (please state)

- White – English/Welsh/Scottish/Northern
- Irish/British
- White – Irish
- White – Other (please state)

- Other ethnic group (please state)

- Prefer not to say
- Other, please tell us:

**Do you consider yourself to be disabled?**

- No
- Prefer not to say
- Yes - Physical impairment, such as difficulty using arms or mobility issues which may mean using a wheelchair or crutches
- Yes - Sensory impairment such as being blind/ having serious visual impairment, or being deaf/ having a serious hearing impairment
- Yes - Mental health condition, such as depression, anxiety or schizophrenia
- Yes - Learning disability/difficulty (such as Down's Syndrome, dyslexia, dyspraxia) or cognitive impairment (such as autistic spectrum disorder)
- Yes - Long standing illness or health condition, such as cancer, HIV, diabetes, chronic heart disease or epilepsy
- Yes - Other (please tell us)

**If you would like to be kept informed about the future of this project, please provide us with your name and email address.**

Name

Email

Any personal information that you have supplied will be held by South Gloucestershire Council and Thornbury Town Council in accordance with the Data Protection Act. This information will only be used as part of this exercise and personal information will not be published or passed onto any other organisation.

Further information and a link to our online survey is available from each organisations website or from this link: [www.southglos.gov.uk/consultation](http://www.southglos.gov.uk/consultation)

You can also tell us your views by emailing: [consultation@southglos.gov.uk](mailto:consultation@southglos.gov.uk)

Or writing to: **Freepost RTXL-YJXJ-BXEX  
South Gloucestershire Council  
Corporate Research & Consultation Team  
Thornbury Community Facilities  
Council offices  
Badminton Road  
Yate  
BRISTOL  
BS37 5AF**

You can also call **01454 412103**.

Please return this survey to the freepost address or to the Town Hall, Library or Turnberries